

## ANSWERS TO SUBMITTED QUESTIONS – NEW STV DESIGN

QUESTION: What was the inspiration for the revised church design?

ANSWER: Please see the attached pictures from the Transfiguration Cathedral in Tver, Russia. This design can be found throughout the cities of that area of Russia.

QUESTION: The drawing shows 2 levels of a new building, but details are only about the main floor

ANSWER: Please see attached sketch using Fr. Gregory's 7<sup>th</sup> Grade Technical Drawing class expertise. But we hope that this will give you a good idea until we can provide the architect's more professional drawings.

QUESTION: Why is the new proposal south of the existing church while the previous proposal was north of the existing church?

ANSWER: There are various reasons. One quite logistical reason is that by attaching the new design to the present church we can utilize the bathrooms in the present church. This saves a significant amount of money. Also, by attaching our new church to the old church we express architecturally our growth from the old church to the new church. Leaving the field where we hold our annual festival as is both allows us to continue the festival, as well as reserving that space for future generations of St. Vladimirians to build an even greater cathedral for God's glory once we have filled the revised design church. There are other reasons as well, but these are probably the most significant.

QUESTION: Can you please explain in detail the reasons for the significant difference in estimated cost?

ANSWER: The revised design is significantly architecturally simpler than the original design. It is essentially, in design, a box. The original design was exceedingly architecturally complex. And that led to it being exceedingly expensive. That does not mean that the revised design will not be beautiful. In fact it will be (see pictures of the Transfiguration Cathedral attached). We will not copy that design completely, but it is very close, and we should expect our new church to be at least as beautiful as that cathedral, if not more so.

QUESTION: What's the size/capacity of the new design compared to the original? And what's the cost difference?

ANSWER: Size comparison – in fact the revised design is a bit smaller (56 square feet) than the original design. At least as far as space for the faithful to stand. Both are about three times larger than the present STV. A financial comparison, beginning with a one-page executive summary, can be found here:

### [FINANCIAL COMPARISON ORIGINAL VS. REVISED DESIGN](#)

QUESTION: May the new church design include the current church building into part of the design? It seems rather strange for many reasons to have an estranged building right next to the new one. Even if it would only be used as a chapel for the church school...

ANSWER: Here we say, with all love and respect, experts are working on the design of the church and how the two churches relate to each other. There are few priests that have visited more parishes in Russia, Ukraine, and ROCOR than Fr. Gregory. The revised design is not strange at all in fact. You find this not at all uncommonly in villages in the old world. First, a small church is built. Then the village grows and a new, larger church is built, with the original becoming a side chapel, attached to the new church. This is exactly what is happening in the revised STV design.

QUESTION: Why is the new church so much cheaper than the original design? Cheaper materials? Also, why didn't we begin with this cheaper design rather than the original one which is much more expensive? And why is it so close to the current church building compared to the original design?

ANSWER: We have answered the question of finance above, so no need to address it here again. Also, why the new design is attached to the present STV. But the question of why we didn't begin with the revised design is a good one. The answer is: this is often how God's will works. We do our best, but if/when it becomes clear that our efforts are not in serving God's will, we make every effort to fail quickly and again seek to do God's will. It is an important virtue to persist. But it is important to be wise also. We have no idea why we did not come up with the revised design first. The Lord did not lead us in that direction it seems. But rather, He led to the revised design THROUGH the original design. That is, we were not able to consider the revised design, even to imagine it, without first having designed the original church, and then having realized that we had neither the resources nor the time to build it and keep our community united. Once we realized that, the revised design somehow became obvious. We then addressed this with our architect, and the revised design became a reality on paper. It is our work, as a parish family, to now decide if the unanimous recommendation of the parish council to pursue the revised design is in fact wisdom. I (Fr. Gregory writing) believe the parish council is completely correct in its recommendation. The revised design can be built in approximately one year. The original design would have taken at least 5 years. Perhaps more. As a parish community we simply do not have 5 years to burn. We are bursting at the seams in our present STV, and it would be rightly considered malpractice by the faithful if we did not do everything we could to alleviate that problem. Because if we do not – people will leave. And we will answer for those lost souls.

QUESTION: I guess I came late to see what the original plans were. What is the size difference between this and Konstantin's plan? Was it always meant to be south of the existing church? Does the cost include the ikonostasis and all iconography, or is there going to be a future phase of paying for that? What will become of the existing church? Do I need to put more in the collection for asking more than one question on this form?

ANSWER: To the last question: yes. :) We will address the questions you ask that have not already been answered above.

FIRST, the cost – the answer is true for either design. The ikonostasis should be included in the cost. Likely we will offer the icons IN the ikonostasis for people to sponsor. The frescoes will come not sooner than 10 years after the completion of construction, so that would be a future phase. And this probably would be the work of our children and grandchildren. And this is perfectly fine – even good. The Church is alive, and so each parish must be alive as well. Christianity is a religion of growth, not of stasis. If we live long enough to execute the iconography, thank God. If not, we can have hope that our descendants will assure that this work is completed for God's glory.

SECOND, the present church – the answer is true for either design. Archbishop Peter asked us to build an adult, walk-in, baptismal font in the middle of the existing church. This assures that everyone must go "through" the old church to get to the new. We presently serve liturgy every Wednesday in the church as the foundation of the Law of God program in our Ann Arbor Orthodox Classical Academy.

This will continue. So liturgy would be served at least every Wednesday in the present church. It is likely that other weekday services would be served there as well, but that will have to be decided as the Lord guides us going forward.

QUESTION: Is it possible/allowed to start by building just the church building and moving the altar, relics under the altar and iconostasis to the new building and using the existing as a fellowship hall?

ANSWER: Essentially, no. After 40 years of the Divine Liturgy being served in the present STV it is not really spiritually appropriate to use it for other activities. It is also not logistically possible to move all those things you suggest from the present STV to the revised design (or to the original design for that matter). If you would like to discuss these things in more detail please contact Fr. Gregory. And please note, we are building a new hall directly to the north of our largest parking lot. This hall will be built at the same time as the revised design. To be honest, even if we could turn the present STV into a hall, it would be inadequate for the needs of our community. That is, it would be too small.

QUESTION: If the bathrooms from the existing church will be reused for the new church, will additional bathroom space be added? Two bathrooms is already tight for the existing church and would be even more so with three times the space and people.

ANSWER: Yes. The existing kitchen will be turned into bathroom space that should, in addition to the two existing bathrooms, be adequate. We will work closely with the Lima Township Planning Commission to assure that all applicable ordinances in this regard will be followed.

SEE ATTACHMENTS ON SUBSEQUENT PAGES!

We thought it would be interesting and helpful for folks to see what inspired the revised design, so that it is possible to envision what the revised designed STV might look like. We are not copying the Transfiguration Cathedral in Tver completely, but the revised design will be similar to the pictures below. NOT EXACTLY, but this is what motivated our design, so it is informative most certainly...

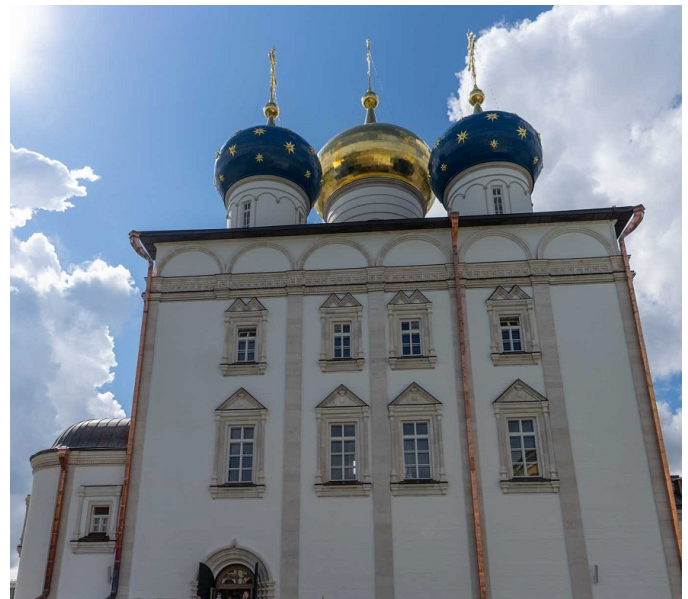
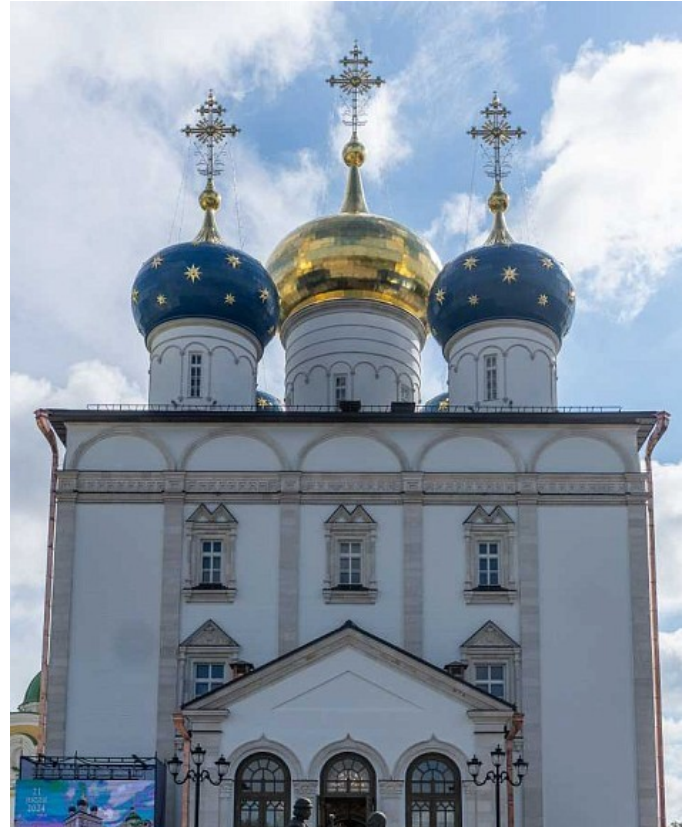
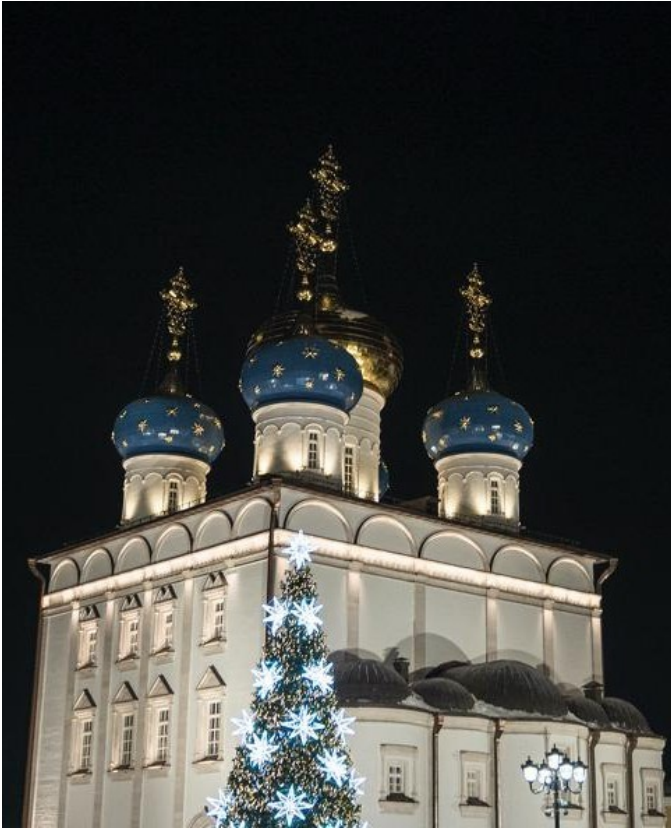

1 SQUARE =  
1 FOOT

# FLOOR 2 NEW STU

STORAGE  
400ft<sup>2</sup>

STORAGE  
400ft<sup>2</sup>

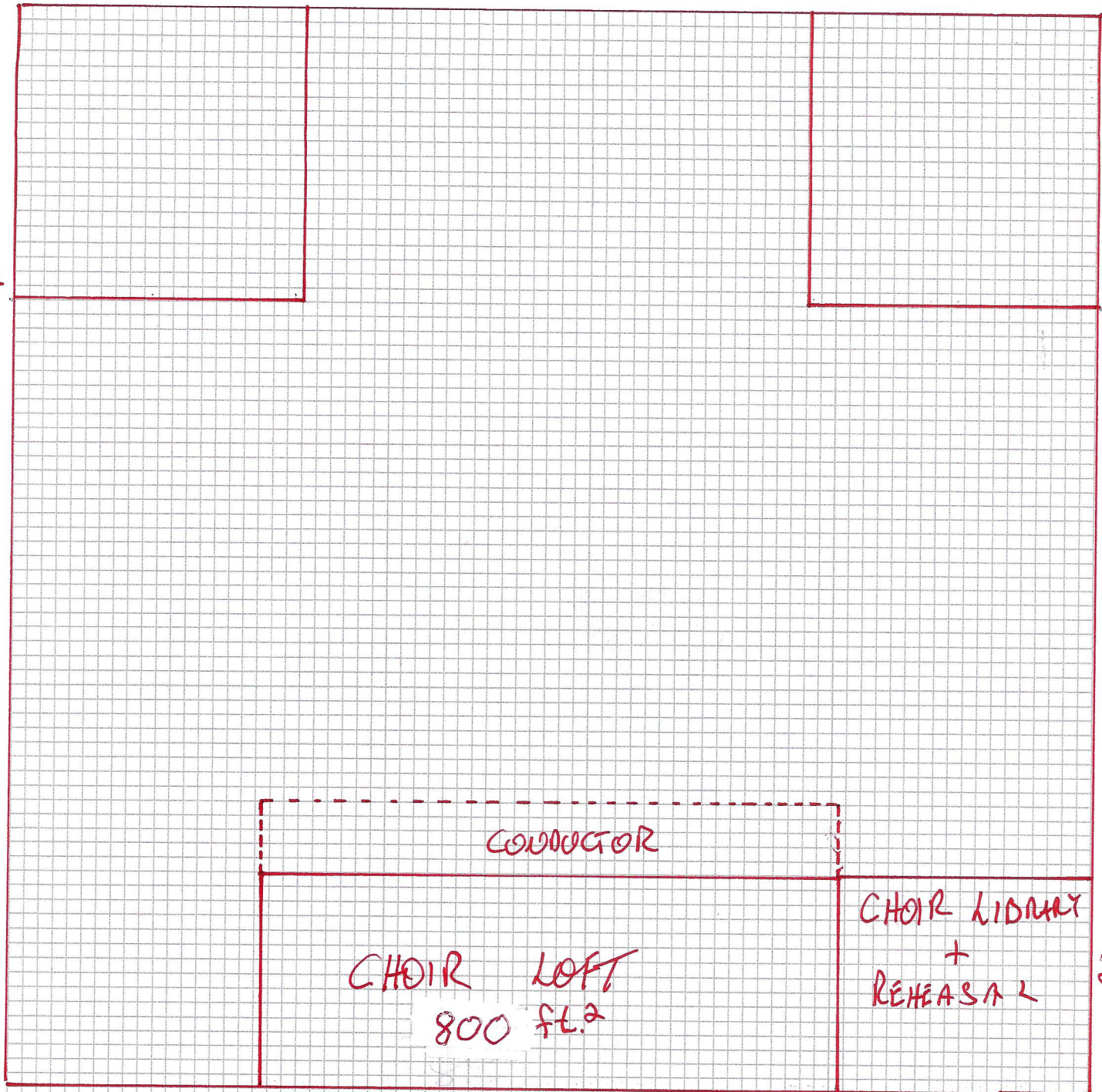

CONDUCTOR

CHOIR LOFT  
800 ft<sup>2</sup>

CHOIR LIBRARY  
+  
REHEARSAL

263 ft<sup>2</sup>